



## Tuscany Villages Fact Sheet

### General information

Name of the village	<b>PECCIOLI</b>
Province	PISA
Tourist information	<p><b>Tourist Information and Reception</b>                  Piazza del Popolo, 5 c/o Palazzo Pretorio. 56037                  Peccioli - Pisa Tel: +39 0587 936423  <a href="mailto:turismo@comune.peccioli.pi.it">turismo@comune.peccioli.pi.it</a></p> <p>Accessible by ramp and slope less than 8% equipped with handrails</p>



**TESTED BY:** [Handy Superabile Social Promotion Association](#) in 2024

**Please note** The following information refers to the date of verification shown at the bottom of each sheet. **The Association** is not responsible for any significant changes made by the property after the visit.

#### Summary

Villages .....	1
General information .....	1
Description .....	2
How to reach Peccioli .....	2
Car park .....	4
Route from the car park to the entrance .....	5
Description of the itinerary .....	6
Any accessible bars/restaurants .....	18
Communal toilets .....	19
Medical practices/healthcare facilities .....	22

Project carried out with the contribution of the





## Description

**Peccioli** is a combination of medieval architecture and contemporary art, with a historic center that can be defined as an open-air museum.

## How to reach Peccioli

<b>By car</b>	Peccioli is easily accessible from all the main cities in the region. Just 15 km from the town are the <b>Pontedera exits</b> of the FIPILI Great Communication Road that connects Florence, Pisa and Livorno
<b>By plane</b>	Pisa airport 40 km away
Assistance service for people with disabilities	YES
Embarkation/disembarkation of passengers with reduced mobility	with courtesy chair and ambulift /Finger
Tactile paths for the blind and visually impaired	YES
There is a toilet room accessible with grab handles	YES
<b>By train</b>	
Nearest station	The Peccioli area is well served by the <b>Pontedera-Casciana Terme train station</b> , 18 km away, with regular trains leaving every hour or half an hour throughout the day
Assistance service for people with disabilities	YES
Blue Hall Reference	Location Florence

Project carried out with the contribution of the





Carriage access	with forklift/ramp
There is a toilet room in the station accessible with grab handles	YES
<b>By public and private transport</b>	
Nearest bus stop	there is an extra-urban bus service managed by Autolinee Toscane, which connects Peccioli and its hamlets i at Pontedera station
Presence of adapted buses with ramp	It is recommended to contact Autolinee Toscane to ask for confirmation and for the timetables <a href="https://www.at-bus.it/it">https://www.at-bus.it/it</a>
Presence of taxis with adapted ramp	NO
Eventual notes	





**Car park**

<p><b>Public parking nearby</b></p>	<p>YES Fonte Mazzola Amphitheater Parking                  - Multi-storey Parking (payment) Piazza San Bartolo Parking Via dei Cappuccini Parking Piazza del Carmine Parking Piazza Fra Da Peccioli Parking Via della Resistenza Parking</p>
<p>Type of public parking floor</p>	<p>asphalt</p>
<p>Presence of parking space reserved for people with disabilities</p>	<p>YES 3 reserved seats in Piazza del Carmine</p>
<p>Eventual notes</p>	
	





In Via Mazzini there is a multi-storey paid car park with a large lift, equipped with a Braille keyboard, to reach the town in Via del Giardino.

The multi-storey car park is subject to charges. For stays of less than 60 minutes it is free. Hourly cost €1.



For the disabled, holders of the CUDE badge, it is possible to have free admission, with reserved spaces on each floor, by sending an email attaching a copy of the vehicle's registration document to [info@belvedere.peccioli.net](mailto:info@belvedere.peccioli.net)

There are toilets adapted for the physically disabled on the first floor.



### Route from the car park to the entrance

Route from the car park to the starting point	flat
<b>Distance</b> from parking to entrance	50 meters
<b>Type of trail surface</b>	asphalt
There are <b>indicators and tactile maps</b>	NO





## Description of the itinerary

Length	300 m
Along the itinerary there are <b>maps and tactile signs</b> for the blind	NO
<p>Description of the itinerary</p> 	<p>Our itinerary starts from Piazza del Carmine. Here we find the <b>Church of the Carmine</b> accessible via a short ramp to access the churchyard and a second short ramp to access the interior, with slopes that do not exceed 8%.</p> <p>The church was built in 1642 in bricks and is surrounded on three sides by a loggia. Inside, two plaques in memory of the earthquake that destroyed the church in 1846, totally restored four years later.</p>
	





Continue from Piazza del Carmine and at the end of the square, at number 33, on the left we find the **Archaeological Museum**

The Museum is accessible via a 120 cm long ramp, with a 7% slope and sliding door; the internal rooms are accessible on the flat or with ramps. The Longobardi room is accessible via a 454 cm long ramp with a 20% slope.

The museum is developed within a system of tunnels that in ancient times contained underground tombs.

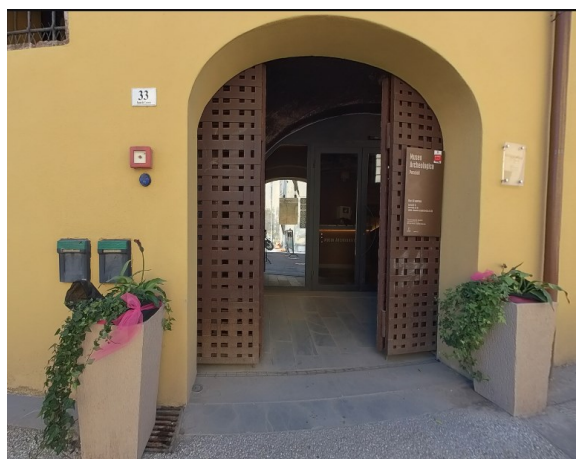

The museum houses the finds found within the municipal territory, especially in the Etruscan site of Ortaglia and in the Archaeological Area of Santa Mustiola  
Phone +39 0587 672158 - +39 0587 936423  
E-mail [info@fondarte.peccioli.net](mailto:info@fondarte.peccioli.net) Free admission - Opening hours from 1/11 to 31/3: Wednesday from 15:00 to 19:00, Saturday, Sunday and holidays from 10:00 to 13:00 and from 15:00 to 19:00. From 1/4 to 31/10: Wednesday from 16:00 to 20:00, Saturday, Sunday and holidays from 10:00 to 13:00 and from 16:00 to 20:00.





A little further on we find the Multipurpose Center which has two rooms and an urban terrace intended for events and exhibitions

The structure is accessible on the flat and inside a bathroom equipped for the motor disabled



Continue along Corso Giacomo Matteotti until you reach Piazza del Popolo.

The flooring is made of concrete tiles that can be easily walked on in a wheelchair





Palazzo Comunale, in Piazza del Pololo, number 1

Accessible via 3 steps that can be overcome via a 430 cm long side ramp, 126 cm wide and 4% slope



Just past the Town Hall on the left you reach the Praetorian Palace and the Parish Church of San Verano with the museum of sacred art, one in front of the other

The **Parish Church of San Verano**, in Piazza Fra' Domenico da Peccioli, can be reached via a short ramp 43 cm long with a 19% slope and entrance with an internal step 12 cm high and a removable wooden ramp which, however, was not present at the time of the visit.





The **Parish Church of San Verano** was built in the eleventh century and is one of the best examples of Pisan Romanesque style buildings.

The bell tower dates back to 1885, the work of the architect Bellincioni.

Inside the Christian temple there are ancient works by Tuscan and Italian artists. The Crucifix behind the altar dates back to the eighteenth century

Free admission - phone +39 0587 672158  
- +39 0587 672877

[info@fondarte.peccioli.net](mailto:info@fondarte.peccioli.net)



### **Museum of Sacred Art**

Inaugurated in 2009, it is located inside the Parish Church of San Verano, **in the Chapel of the Assumption**, accessible via a 190 cm long ramp with an 8% slope and a door with a width of 116 cm.





The **chapel** was added to the parish church in 1580 to house the Compagnia dell'Assunta. Inside there are valuable works, including seventeenth-century paintings by the painter Jacopo Vignali. The ancient coffered ceiling in gilded wood is admirable. Inside the chapel there are the priory bench and the singers' benches, built in the seventeenth century.

To access the second room, you have to overcome an internal step 8 cm high



In front of the Parish Church of San Verano we find the **Palazzo Pretorio** in Piazza del Popolo, 5, tel. 0587 672158. The Palace is accessible from the entrance of the Tourist Information office through 3 steps that can be overcome on the flat by means of a side platform equipped with a handrail.

On the way from the ticket office to the lift, you have to overcome a double ramp 693 cm long with a maximum gradient of 13%.





The elevator that leads to the 4 exhibition floors has a door with a width of 79 cm, a width and depth of the cabin 111x136 cm and an internal button keypad that is 130 cm higher.

To reach the 5th floor where the balcony is located between the roofs it is necessary to use a stairlift which was not working at the time of the visit.

The equipped toilet is located on the second floor



The ancient **Praetorian Palace**, dating back to medieval times and remodeled between the eighteenth and nineteenth centuries

Inside the Museum there are three collections: "F. Bigazzi" Collection of Russian Icons, Belvedere S.p.A. Collection of Icons, Engravings and Lithographs Collection

- [info@fondarte.peccioli.net](mailto:info@fondarte.peccioli.net) Free admission  
- Hours Tuesday 9.00 am – 1.00 pm  
Wednesday 3.00 pm – 7.00 pm  
Saturday, Sunday and holidays 10.00 am – 1.00 pm, 2.00 pm – 7.00 pm





	<p>On the first floor there is a 170 cm long ramp with a 16% slope, while the second and third floors are flat.</p> <p>On the fourth floor, a 205 cm long ramp with a slope of 12.5 %</p> <p>Accessible toilets are located on the second floor accessible (see Toilets tab)</p>
	
 	<p>After passing the Parish Church of San Verano and the Praetorian Palace, continue straight on Via Carraia where at number 11 we find the entrance to the <b>Timeless Palace</b></p> <p>The entrance is accessible only via two steps; for those with reduced mobility, it is recommended to reach the Panoramic Terrace through Via Bastioni, uphill, with a first ramp 8 meters long, with a slope of 8/12% and a final ramp under a tunnel, 15 m long with a slope of 15%.</p>





From the panoramic terrace you enter the atrium of the **Palazzo senza Tempo**, where there is the elevator that connects the floors, with the exception of the last one which can only be reached by stairs or stairlifts.

The width of the elevator door is 80 cm, car width and depth 92X130 cm, call button 112 cm high.

Inside, on the second floor, there is also a cafeteria. Here there are also two equipped toilets, on the ground floor and near the cafeteria (see toilets section).

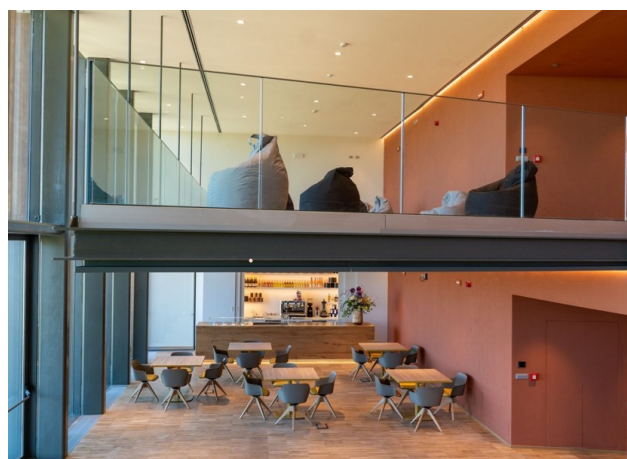



Last but certainly not least is the evocative work of art **Endless Sunset** by Patrick Tuttofuoco created in 2020 in Peccioli to transform the simple walkway that connects the ancient heart of the village to its most modern part into a work of art.

The shape of the circle recalls cyclicity, the passage of time, The idea of applying a chromatic gradient to this three-dimensional shape that takes up the 45 minutes in which the sky sets is great.

The work is part of the **MACCA (Open Air Museum of Contemporary Art)**, a widespread museum that extends over the entire territory of Peccioli and its hamlets

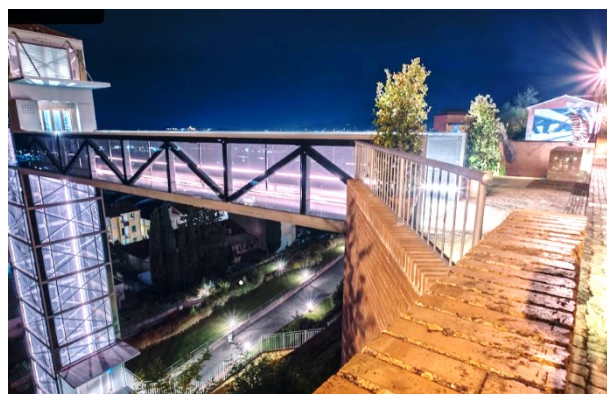



Outside the town, about 9 km away, we find the **Green Triangle Ecological Park and the Statues of the Giants**, which can be reached by car by reservation. They are also part of the **MACCA (Open-Air Museum of Contemporary Art)** where there are **two majestic sculptures**, from 5 to 9 meters high, made of polystyrene and polyurethane foam, covered with cement fibers resistant to external agents. The other two are located at the **Amphitheater of Fonte Mazzola and on the roof of the business incubator in**



It has a dirt car park mixed with grass, with parking spaces reserved for the disabled, during organized events and assistance staff.

The path to the amphitheater and the covered pavilion is quite passable even by those in wheelchairs.





The Green Triangle is an area that goes far beyond the simple definition of a **landfill**, managed by the **Belvedere SPA** company, this structure has been transformed into a real multifunctional center, where the creation of clean energy is only a part and integrates with conferences, fashion shows, concerts inside an enchanting amphitheater and much more.

Inside there is a multimedia station with toilets equipped with a 50 cm high toilet, open front tooth, grab bars even if poorly positioned and front and right side space of more than 90 cm. Open type floor-level shower with wall-mounted seat and flexible





### Any accessible bars/restaurants

<b>Type of venue</b>	Ristorante Audha in via G. Matteotti, 1
<b>How to access</b> the premises	<input checked="" type="checkbox"/> flat
Useful <b>width of door/entrance gate</b>	Above 80 cm
Type of <b>door</b>	with 2 doors that can be opened outwards
Type of <b>handle</b>	bar horizontal
<b>Bar counter</b>	less than 100 cm
<b>Buffet counter</b>	missing
Types of <b>tables</b>	Choose an item.
Space under floor <b>tables</b>	4-legged with space underneath more than 65 cm
<b>Braille menu</b>	NO
<b>Table service</b> for people with disabilities	YES
Eventual notes	





Inside the restaurant, accessible on the floor, there are equipped toilets  
 Usable door width of more than 80 cm, 50 cm high toilet with open front tooth, with fixed handle on the right and space on the left side and front of more than 90 cm.

### Communal toilets

There is an accessible toilet	YES
Location of the toilet room	in the Praetorian Palace on the second floor
<b>How to access</b> the premises	Flat
Usable <b>width of the entrance door</b>	of the anteroom 80 cm and of the bathroom 80 cm
Type of door	with inwardly opening door
Type of <b>handle</b>	lever

Project carried out with the contribution of the





Toilet height	50 cm
<b>Toilet seat</b> with open front tooth	YES
<b>Support handles</b>	Reclining handle on the right and fixed wall handle on the left but not on the side of the toilet.
<b>Flexible shower</b> on the side of the toilet	NO
<b>Free space</b> on the sides of the toilet	left 30 cm right Above 90 cm frontal Above 90 cm
<b>Electric doorbell/telephone</b> on the side of the toilet	NO
<b>Washbasin</b> with space underneath for wheelchair approach	Above 70 cm
Height from the ground lower edge <b>mirror</b>	not sufficient for use by a person in a wheelchair
<b>Baby changing table</b>	NO
Eventual notes	
	

There is an accessible toilet	YES
Location of the toilet room	in the Palazzo Senza Tempo in the basement where the cafeteria is located
<b>How to access</b> the premises	Flat





Usable <b>width of the entrance door</b>	of the anteroom 80 cm and of the bathroom 80 cm
Type of door	with door that can be opened outwards
Type of <b>handle</b>	knob
Toilet height	45 cm
<b>Toilet seat</b> with open front tooth	NO
<b>Support handles</b>	Reclining grab bar on the left and fixed wall grab bar on the right
<b>Flexible shower</b> on the side of the toilet	NO
<b>Free space</b> on the sides of the toilet	left Above 90 cm right 25 cm frontal Above 90 cm
<b>Electric doorbell/telephone</b> on the side of the toilet	YES
<b>Washbasin</b> with space underneath for wheelchair approach	Above 65 cm
Height from the ground lower edge <b>mirror</b>	not sufficient for use by a person in a wheelchair
<b>Baby changing table</b>	NO
Eventual notes	



Project promoted by



Regione Toscana

## Medical practices/healthcare facilities

Hospitals near the property	<b>Felice Lotti Hospital</b> Via Roma, 147, Pontedera distance: 14 km <b>Azienda Ospedaliera - Universitaria Pisana</b> Via Cisanello Pisa distance: 31 km
Other healthcare facilities	<b>AZIENDA USL N.5 PISA-ZONA VALDERA</b> Piazza del Carmine PECCIOLI (PISA) Tel. +39.0587636329 <b>Dialysis department</b> at the Lotti Hospital in Pontedera under construction

TESTED BY: [Handy Superabile Social Promotion Association](#) in 2024

Project carried out with the contribution of the



Presidenza del  
Consiglio dei Ministri  
Ministro per la disabilità